



AGR-V MIXER

OVERVIEW

The AGR-V series are slow speed gearbox mixers. The shaft of the mixer is key coupled with the hollow of a worm gear box for efficiency. As such they are designed for mixing flocculants and neutralisers or for flocculant solution preparation.

The AGR-V is equipped with either 2 or 4 blade 45° impeller with shaft materials ranging from SS304L, SS316L, rubber ebonite and steel core polypropylene.



TECHNICAL FEATURES

- **Shaft Length** 70 – 150 cm
- **Power** 400 V 50 Hz 3-phase or 230 V 50 Hz 1-Phase
- **Poles** 4, 6, or 8 poles
- **Motor** 0.18 to 1.5 kW
- **Impeller** 4 blades at 45° or 3 blades at 45° for mixers with 0.18 kW

DIMENSIONS

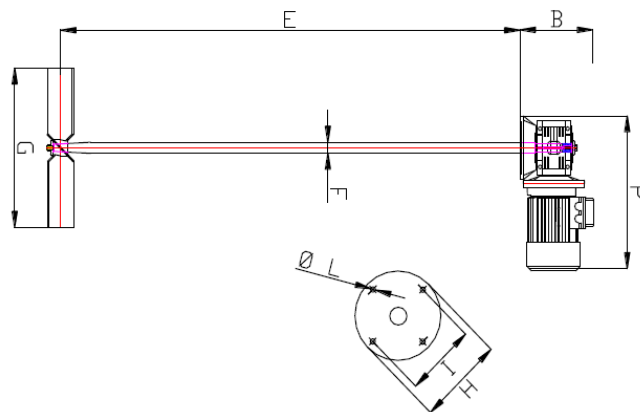

| Motor | | Dimensions | | | | | | | | Mass |
|-------|-----|------------|------|----|-----|-----|-----|------|-----|------|
| kW | RPM | B | E | F | G | H | I | L | P | kg |
| 0.18 | 140 | 140 | 700 | 25 | 200 | 140 | 115 | 4x9 | 320 | 17 |
| 0.25 | 90 | 180 | 800 | 30 | 300 | 160 | 130 | 4x10 | 360 | 22 |
| 0.37 | 90 | 180 | 1000 | 30 | 350 | 160 | 130 | 4x10 | 360 | 24 |
| 0.55 | 90 | 220 | 1000 | 35 | 400 | 200 | 165 | 4x12 | 420 | 35 |
| 0.75 | 90 | 220 | 1200 | 35 | 500 | 200 | 165 | 4x12 | 420 | 37 |
| 1.1 | 90 | 250 | 1500 | 35 | 550 | 200 | 165 | 4x12 | 500 | 40 |
| 1.5 | 70 | 250 | 1500 | 40 | 700 | 200 | 165 | 4x12 | 520 | 60 |



PRODUCT CODES

| Model | | | | | | | | | |
|-------|-------|-------------|--|---|---|---|---|---------|--|
| AGT | Mixer | | | | | | | | |
| | Type | | | | | | | | |
| | 3 | AGR-V | | | | | | | |
| | | Power Motor | | | | | | | |
| | | 2 | 0.18kW | | | | | | |
| | | 3 | 0.25kW | | | | | | |
| | | 4 | 0.37kW | | | | | | |
| | | 5 | 0.55kW | | | | | | |
| | | 6 | 0.75kW | | | | | | |
| | | 7 | 1.1kW | | | | | | |
| | | 8 | 1.5kW | | | | | | |
| | | | Number of Poles | | | | | | |
| | | 4 | 4 Poles | | | | | | |
| | | 6 | 6 Poles | | | | | | |
| | | 8 | 8 Poles | | | | | | |
| | | | Power Supply | | | | | | |
| | | 1 | Three Phase | | | | | | |
| | | 2 | Single Phase (0.18 - 0.25 kW or 0.37kW) | | | | | | |
| | | | Shaft Length | | | | | | |
| | | 0 | 60cm | | | | | | |
| | | 1 | 80cm | | | | | | |
| | | 2 | 90cm | | | | | | |
| | | 3 | 70cm | | | | | | |
| | | 4 | 100cm | | | | | | |
| | | 5 | 120cm | | | | | | |
| | | 6 | 125cm | | | | | | |
| | | 7 | 150cm | | | | | | |
| | | | Impeller Type | | | | | | |
| | | 1 | 2 Blades at 45° | | | | | | |
| | | 2 | 4 Blades at 45° (3 blades with 0.18kW motors only) | | | | | | |
| | | | Material | | | | | | |
| | | 0 | SS304L | | | | | | |
| | | 1 | SS316L | | | | | | |
| | | 3 | PP | | | | | | |
| | | 4 | Rubber Ebonite | | | | | | |
| AGT | 3 | 6 | 4 | 1 | 4 | 2 | 0 | Example | |